

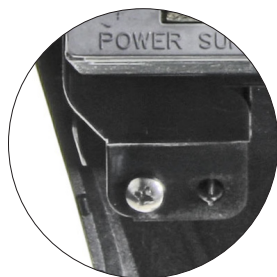

Installation Manual Double DIN Kit

Ford Fiesta 2009-> (Models without display only)

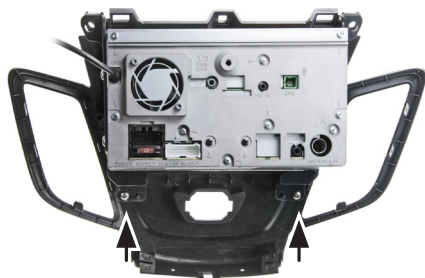

6. Mount Double DIN navigation to fascia plate.

Fix it with 2 Phillips screws
(see arrows)

Connect all required circuit
points

Mount both to the dash
board

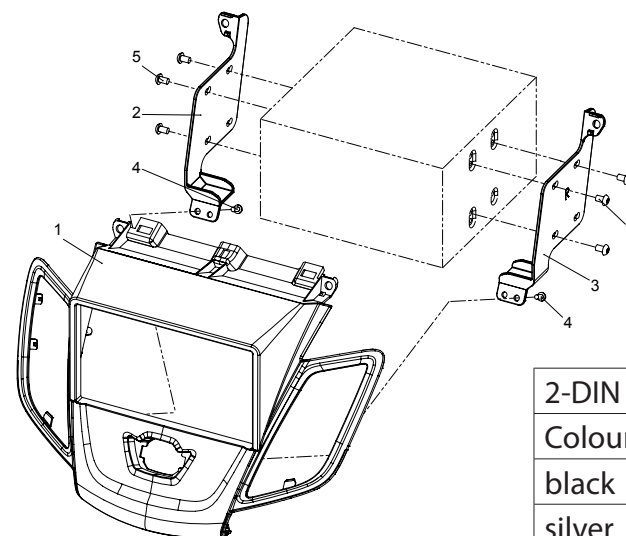

2-DIN (without pocket)

Colour	Part-No.:
black	381114-20-1
silver	381114-20-2

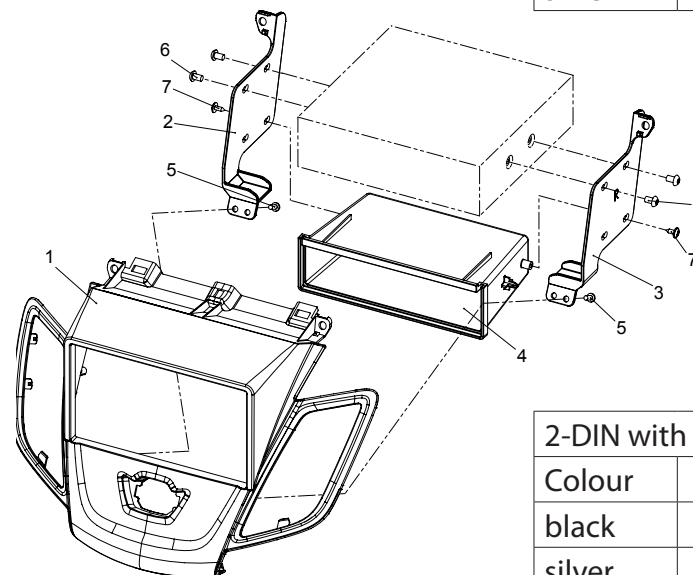

2-DIN with pocket

Colour	Part-No.:
black	281114-20-1
silver	281114-20-2



1. Unclip the panel



2. Remove the panel

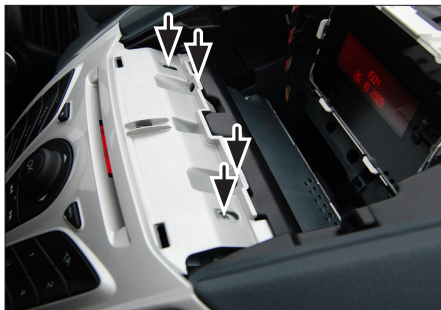

3. Remove the 4 screws of the OEM head unit



4. Remove the OEM head unit

Dismount the air vents

Mount the air vents to the new facia plate



5. Remove the middle bar (cut at the position marked with arrows)



(sample photo)

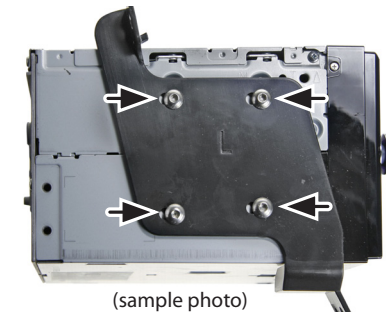

(sample photo)

6. Mount brackets left (L) and right (R) to Double DIN Navigation. Fix them with 8 flat headed hex sockets. Use the 1st. position (right) for screws